

FIRST ADDITION TO UNIVERSITY HEIGHTS ELRENO OKLA.

N.W. 1/4 SEC. 15, T. 12 N. R. 7 W.

1323.05

Scale 1/2" = 100 ft.

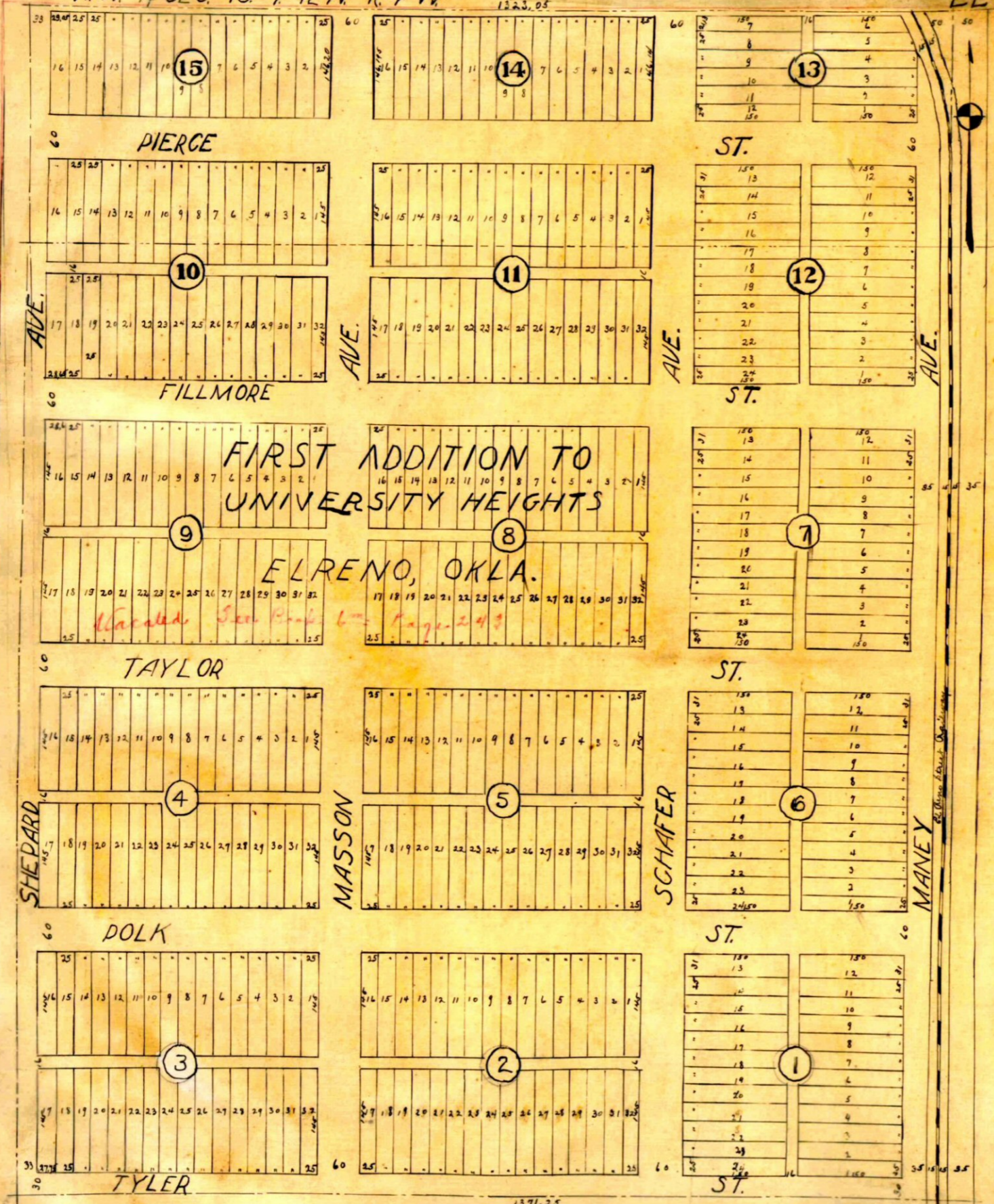

**FIRST ADDITION TO
UNIVERSITY HEIGHTS
ELRENO, OKLA.**

Vacated See Book 6 - Page 243

Government to Plat of First Addition to University Heights, El Reno, Oklahoma.

State of Oklahoma, Canadian County, ss.
 Henry Schaefer, being first sworn according to law, on this 1st day of July, 1909, at the County of Oklahoma, in the office of the Register of Deeds, a just known and designated a First Addition to University Heights El Reno, Oklahoma.

And this official further states that subsequent to the filing of said plat, and prior to the date on which any of the lots in said first addition to University Heights applied for the extension, have not, and that the same have been changed in the register; that in the street widening, running along Shepard Avenue to the southeast corner of Block No. 101, at the intersection of said Shepard Avenue and Fillmore Avenue, said Street Widening has not intersected said first addition to University Heights at Maney Avenue, as the first corner of Block No. 101, as shown by said plat, and will form said southeast corner of said Block No. 101, as shown by said plat, as shown in the original plat, and will be transferred according to the original plat, as shown in the original plat, instead of as shown in the original plat, said lots in said first addition to University Heights will be opened to public purchase and occupation and will be transferred according to the original plat, and made a part of this official.

Subscribed and sworn to before me, this 1st day of July, 1909.

Notary Public, Canadian County, Ok.
 Filed for record, this 7th day of July, 1909
 at 5:30 o'clock P. M.

Ogden Matthews
 Register of Deeds.

Henry Schaefer
 My commission expires Sept. 17, 1909. Registered & Bonded Notary Public.