

JENSEN'S

PART OF

EL RENO

OKLAHOMA, INDIAN TERRITORY.

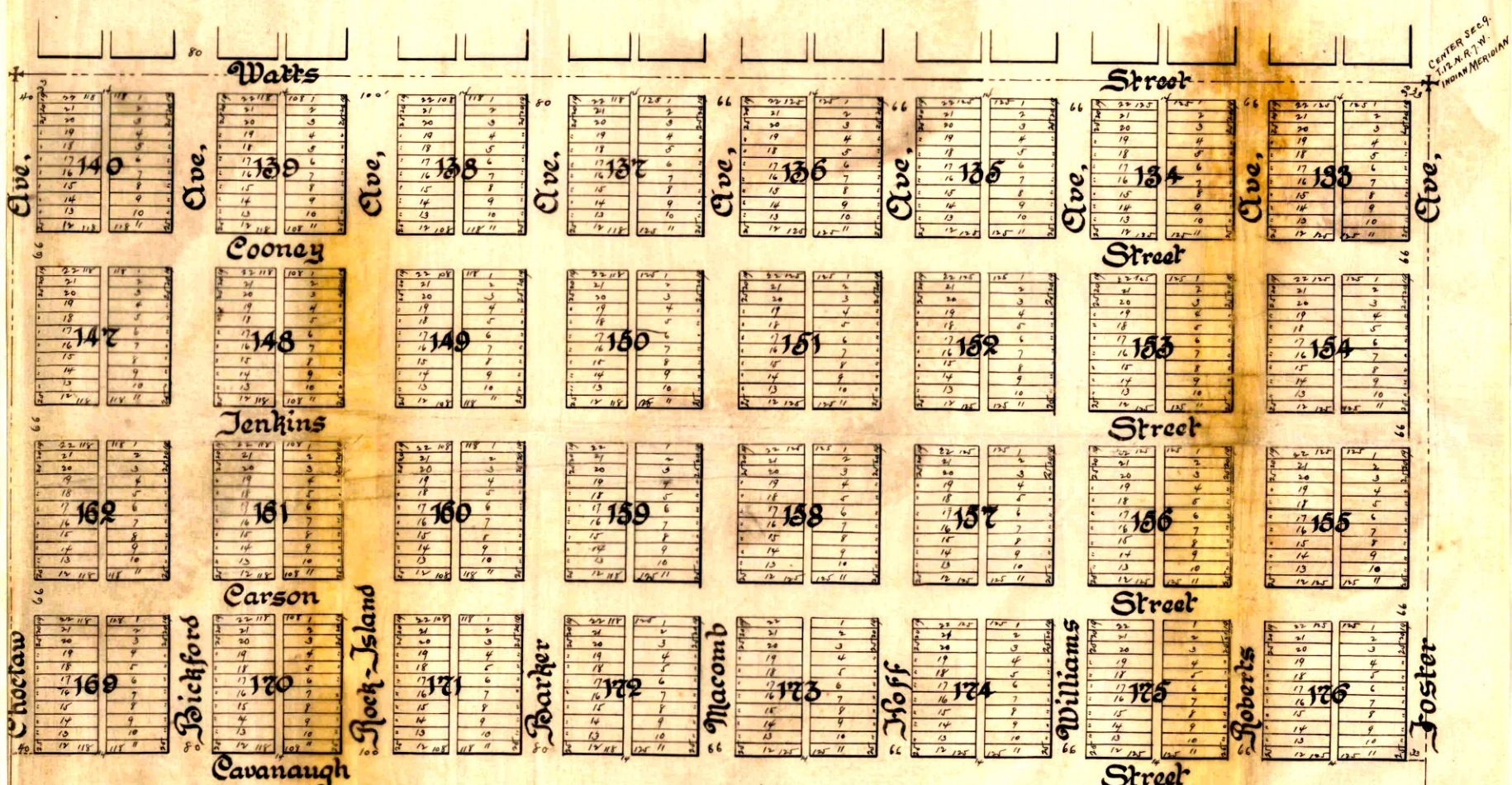

Territory of Oklahoma }
Fourth County } 20.

Thomas Jensen Being duly sworn says he has the Homestead Entry on the land described in the map here that he same is described as follows to wit Being the north half of the South west quarter of Section 9, Township 12 North Range 7 West Indian Meridian; and that the Survey and Platting of said land was made previous to May 2nd 1890 and said land was previous to said date occupied for trade and business Homestead purposes.

Thomas Jensen

sworn to before me this 9th day of August, 1890.
Not. Public

Department of the Interior,
October 28, 1890.

Approved in accordance with the
twenty-second section of the act of
Congress approved May 2, 1890.

W. H. C. Caudle
Secretary

46

W