

However many of these parcels that the Commission County Development Company has owned the above described lands to be surveyed and platted into lots, blocks, streets and alleys as shown and set forth in and by the acknowledged plat to be known and called Robbina Addition to the City of El Reno, State of Oklahoma, all streets and alleys are of the free use of the owner hereby dedicated to and for the use of the public the grantor reserving the right to improve same on west side walk and care for any and all of the said streets when and as may be deemed necessary.

W. C. Blake President
Ray Geo. W. Bellamy Secretary

State of Oklahoma
County of Canadian

Before me a Notary Public, for and in said County and State, on this 28 day of July 1908, personally appeared George W. Bellamy to me known to be the identical person who subscribed the name of the master to the foregoing statement as its President and acknowledged to me that he executed the same as his voluntary act and deed, and as the free and voluntary act of the said corporation for the use and purpose therein set forth.

Notary Public
 J. C. [Name] 1908 July 28

State of Oklahoma
 County of Canadian

J. C. Howe a surveyor hereby certify that I have surveyed and plotted the annexed plat of Robbina Addition to the City of El Reno State of Oklahoma into lots blocks streets and alleys. said addition is located in and bounded as follows, beginning at a point on 1/4 section line 1736.5' East of section 5, thence north 1576.4' and 6' thence East 887.5' to corner of section 5, thence north 1576.4' on 1/4 section line to intersection E & G.R. off of N. thence in north westerly direction 1090' along G.O. R. off of N. thence south 7140' to intersection E.A. & G.O. R. off of N. thence in south westerly direction 55' along side right of way line to point of beginning containing 39.5 acres all in the N.W. 1/4 section 5. Sup 1427. Ringer H. M.

The plat on the margin of which this is written is a correct description thereof of the lots, blocks, streets and alleys one of the dimensions marked upon said plat & blocks being driven at the corners of each block and lot.

J. C. Howe
 Surveyor

State of Oklahoma
 County of Canadian

Filed for record July 29, 1908
 at El Reno, Okla.

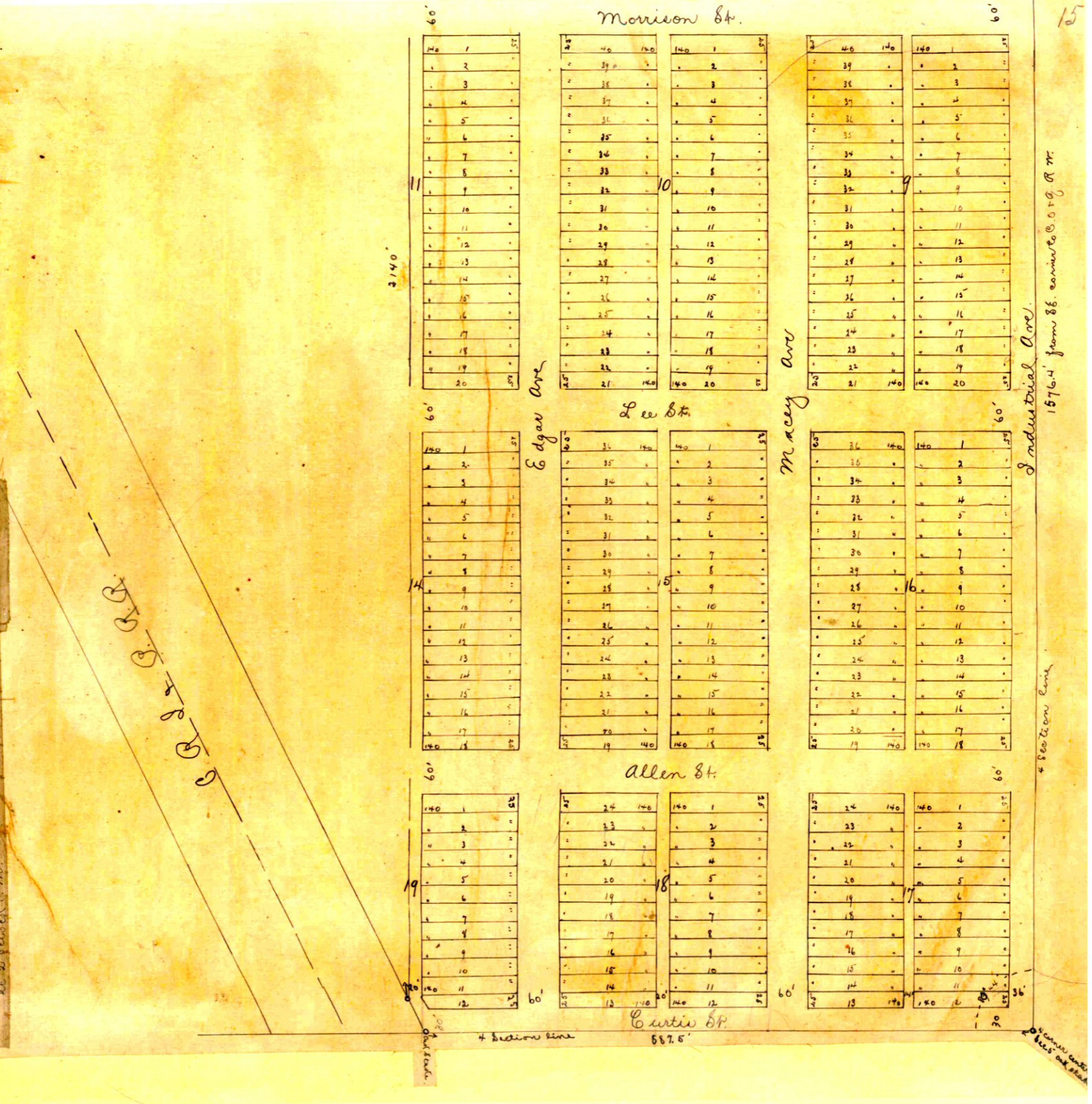

State of Oklahoma
 County of Canadian

Filed for record July 29, 1908
 at El Reno, Okla.

State of Oklahoma
 County of Canadian

Filed for record July 29, 1908
 at El Reno, Okla.

Section Line
 1576.4' from S.E. corner of S.O. 19, R. 7 W.