

SUNFLOWER RIDGE

PART OF THE NE1/4-SE1/4 OF SEC.28,T13N,R6W, I.M.
CANADIAN COUNTY, OKLAHOMA

OWNER'S CERTIFICATE AND DEDICATION

We, the undersigned ERMH, Inc., hereby certify that we are the only person, firm or corporation having any right, title or interest, in and to the land shown on the annexed map or plat and does further certify:

- That as owner of the title to said land which is shown on the annexed plat or map of Sunflower Ridge, a subdivision of part of the NE1/4-SE1/4 of Section 28, T13N, R6W, I.M., Canadian County, Oklahoma hereby dedicate the streets, avenues and drives as shown on said plat or map, for the use of the owners and their successors and assigns and guarantees a clear title to the land so dedicated and has caused the same to be released of all encumbrances so that the title is clear except as shown on the Bonded Abstractor's Certificate.
- That the areas indicated on said plat or map as "Utility Easements" are hereby reserved for the purpose of locating, constructing, erecting, maintaining, surveying, conducting and performing any utility or utility function or service, above or beneath the surface of the ground, with rights of ingress and egress at any time for the purpose of installation, repair, maintenance, operation and removal of any public or quasi-public utility.
- That said property covered by said plat or map and dedication is subject to certain restrictions, reservations, and covenants contained in a separate instrument, which will be filed for record in the office of the County Clerk of Canadian County, Oklahoma subsequent to the filing of this plat.

ERMH, Inc.
Jerry K. Orr
Jerry K. Orr, President

STATE OF OKLAHOMA)
COUNTY OF CANADIAN) SS

Before me, the undersigned, a Notary Public in and for said County and State, on this 14 day of October, 2001, personally appeared Jerry K. Orr to me known to be the identical person who signed the name of the maker hereof to the within and foregoing instrument as its president, and acknowledged to me that he executed the same as his free and voluntary act and deed and the free and voluntary act and deed of said corporation for the uses and purposes therein set forth.
My Commission Expires: 9-12-2004

Amanda Baden
Notary Public

BONDED ABSTRACTOR'S CERTIFICATE

STATE OF OKLAHOMA)
COUNTY OF CANADIAN) SS

The undersigned, duly qualified abstractor, in and for said County and State, hereby certifies that according to the records of said County, title appears to the land included in the annexed plat of Sunflower Ridge (Canadian County, Oklahoma) to be vested in ERMH, Inc. and that on the 17 day of October, 2001, all lands described and referred to are unencumbered by pending actions, judgments, liens, mortgages, claims or other encumbrances except those of record for the year and prior years that there are no outstanding tax sales certificates against said land and no tax deeds are issued to any person.
Executed this 17 day of Oct, 2001.

ATTEST:
Mark L. Babin
Assistant Secretary

Canadian Valley Abstract Company
Jeffrey B. Mohr
Secretary

STATE OF OKLAHOMA)
COUNTY OF CANADIAN) SS

Before me, the undersigned, a Notary Public in and for said County and State, on this 17 day of October, 2001, personally appeared Jerry K. Orr to me known to be the identical person who executed the within and foregoing instrument and he acknowledged to me that he executed the same as his free and voluntary act and deed for the uses and purposes therein set forth.
My Commission Expires: 11/12/02

Amanda Baden
Notary Public

Curve	Radius	Length	Delta	Tangent
1	414.38'	287.84'	39°47'58"	150.00'
2	414.38'	287.84'	39°47'58"	150.00'
3	276.25'	191.89'	39°47'59"	100.00'

Note: Bearings Are Based On
S00°10'06"E Between Monuments
On The East Line Of The SE1/4

(o) Indicates Set 3/8" Iron Pin
With Plastic Cap Marked: PLS1298

Note: To the best of my knowledge
there are no community water wells
within 300 feet of the above property.
All Lots Extend To The Center Line
Of The Road.

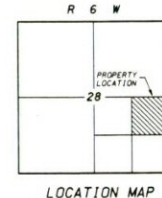

SURVEYOR'S CERTIFICATE

I, Roger Whited, a Professional Land Surveyor, in the State of Oklahoma hereby certify that the annexed plat (consisting of one sheet) of Sunflower Ridge to Canadian County, Oklahoma, represents a carefully surveyed tract made under my supervision on the 12th day of October, 2001. This survey meets or exceeds the current Oklahoma Minimum Standards For The Practice Of Land Surveying as adopted by the Oklahoma State Board of Registration for Professional Engineers and Land Surveyors.

Roger Whited
Roger Whited, PLS 1298

STATE OF OKLAHOMA)
COUNTY OF CLEVELAND) SS

Before me, the undersigned, a Notary Public in and for said County and State, on this 14 day of October, 2001, personally appeared Roger Whited to me known to be the identical person who executed the within and foregoing instrument and he acknowledged to me that he executed the same as his free and voluntary act and deed for the uses and purposes therein stated.
My Commission Expires: June 10, 2002

William M. Smith
Notary Public

LEGAL DESCRIPTION

A tract of land being a part of the Northeast Quarter of the Southeast Quarter (NE1/4-SE1/4) of Section Twenty-eight (28), Township Thirteen (13) North, Range Six (6) West of the Indian Meridian, Canadian County, Oklahoma, said tract further described as beginning at a point on the East line of said NE1/4-SE1/4, 58.00 feet S00°10'06"E of the Northeast corner of said NE1/4-SE1/4, said point of beginning being on the South right-of-way line of the St. Louis, El Reno and Western Railway Company, as described in Book 22 Page 312; thence S00°10'06"E, on said East line, for a distance of 124.32 feet to the Southeast corner of said NE1/4-SE1/4; thence S89°49'54"W for a distance of 1335.38 feet to the Southwest corner of said NE1/4-SE1/4; thence S00°10'06"E, on the West line of said NE1/4-SE1/4, for a distance of 1256.04 feet to the South line of said Railroad right-of-way; thence N89°58'44"E, on said right-of-way, for a distance of 1334.84 feet to the point of beginning, containing 38.472 acres more or less and subject to easements and rights-of-way of record.

COUNTY TREASURERS CERTIFICATE

I, David L. Redick do hereby certify that I am the duly elected, qualified and acting County Treasurer of Canadian County, State of Oklahoma, that the tax records of said county show all taxes are paid for the year 2001 and prior years on the land shown on the annexed plat of Sunflower Ridge to Canadian County, State of Oklahoma, that the required statutory security has been deposited in the office of the County Treasurer, guaranteeing payment of the current year's taxes.
IN WITNESS WHEREOF said County Treasurer has caused this instrument to be executed at El Reno in Canadian County, State of Oklahoma, this 16 day of October, 2001.

David L. Redick
County Treasurer

CERTIFICATE OF DEPT. OF ENVIRONMENTAL QUALITY

I certify that I have approved the application and plan for a plot of a residential development which is on file at the Canadian County office of the Department of Environmental Quality, and hereby approve this plat for the use of individual sewer systems.
Signed this 17 day of October, 2001.

APPROVED
OCT 17 2001
Samuel L. ...
Environmental Specialist
Department of Environmental Quality

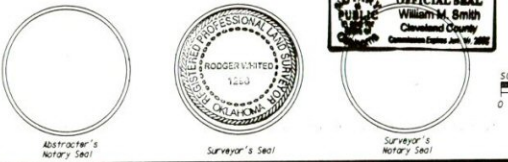

STATE OF OKLAHOMA)
COUNTY OF CANADIAN) SS

Before me, the undersigned, a Notary Public in and for said County and State, on this 17 day of October, 2001, personally appeared Jerry K. Orr to me known to be the identical person who executed the within and foregoing instrument and he acknowledged to me that he executed the same as his free and voluntary act and deed for the uses and purposes therein set forth.
My Commission Expires: 11/12/02

Amanda Baden
Notary Public

FINAL PLAT
SUNFLOWER RIDGE
PART OF THE NE1/4-SE1/4 OF SEC.28,T13N,R6W, I.M.
CANADIAN COUNTY, OKLAHOMA

POLLARD & WHITED SURVEYING INC.
2514 Tee Drive Norman, Oklahoma 73069
C.O. No. 2360 Exp. 6-30-03 405-364-0001

DRAWN BY: RW CHECKED BY: TGP
FILE: 2801300W.DWG Oct. 4, 2001 Sheet 1 of 1