

41-11

29 28
32 33

Sec Line East Act 35 & 28

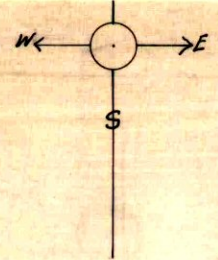

Section Line East Act 35 & 28

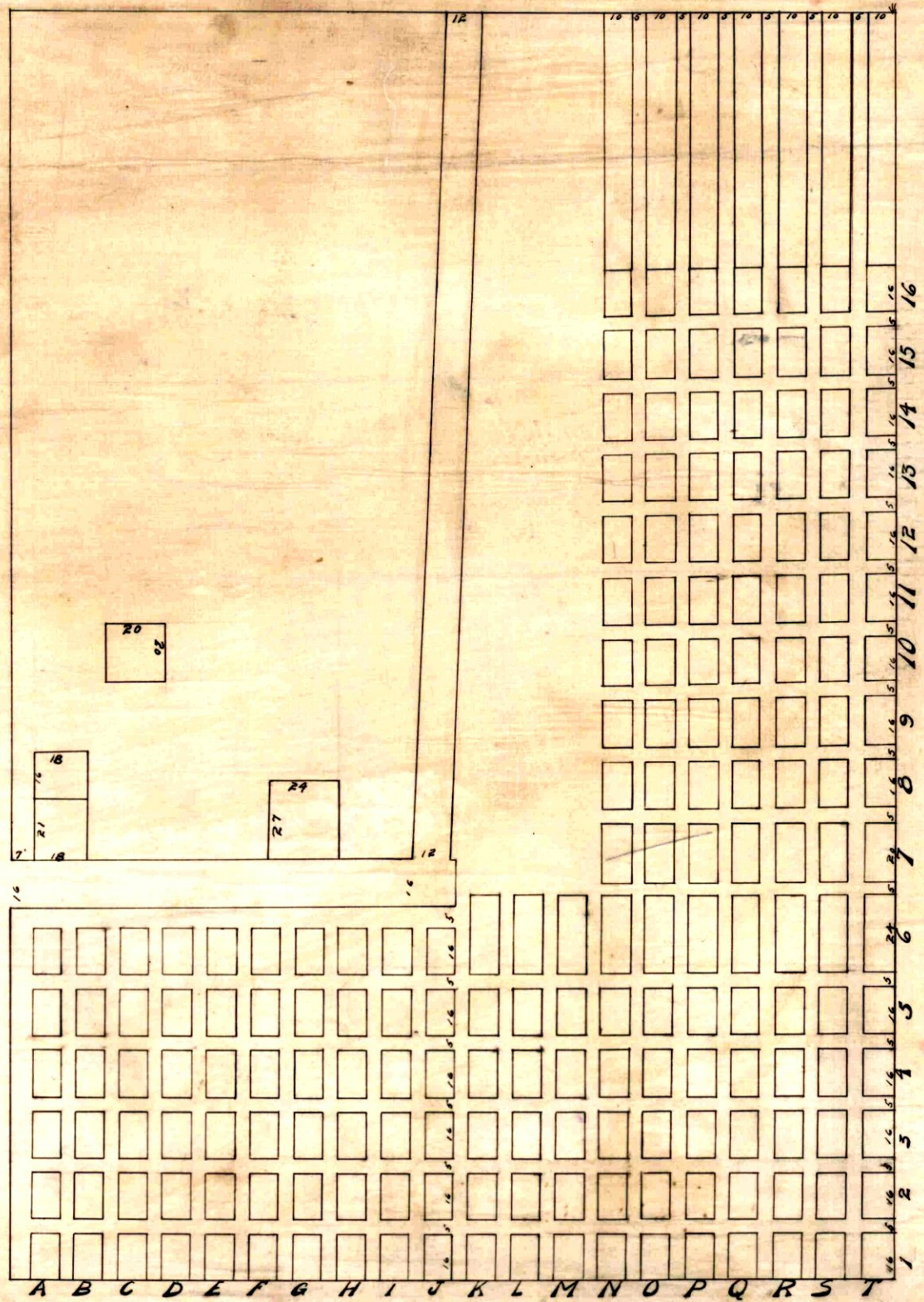

I J.B. STEWART do hereby certify that I have surveyed and plotted The UNION CITY Cemetery into Lots and alleys, dimensions of same as shown on annexed plat are true and correct and is located as follows: beginning at the North West corner of section 33 T10 R7 N Thence east on section 33 335ft. Thence south on right angle line 463ft. Thence west 335ft. Thence north 463ft to place of beginning. The same being sec cor for sections 28, 29, 32 & 33 T 10 R 7 N.

J.B. Stewart County Surveyor

Subscribed and sworn to before me this 25th day of April 1910

L. M. [Signature] Notary Public

My Commission expires July 28th 1913.



STATE OF OKLAHOMA, Canadian County. Filed for record this 23rd day of May 1910 at 2 o'clock P.M. and read page 41. Clyde Matthews Register of Deeds 7400